

PROVIDENCE, R. I.
CITY ENGINEER'S OFFICE
STREET LINE DEPT.

Feb. 18. 1889.

014700

Providence R.I.
This plat accompanies
our report of this date.

PLAT OF WILLIAMS STREET

FROM SOUTH MAIN ST. TO HOPE ST.

IN FOUR SHEETS

SCALE 40 FEET PER INCH

Red lines and figures show lay out as adopted.

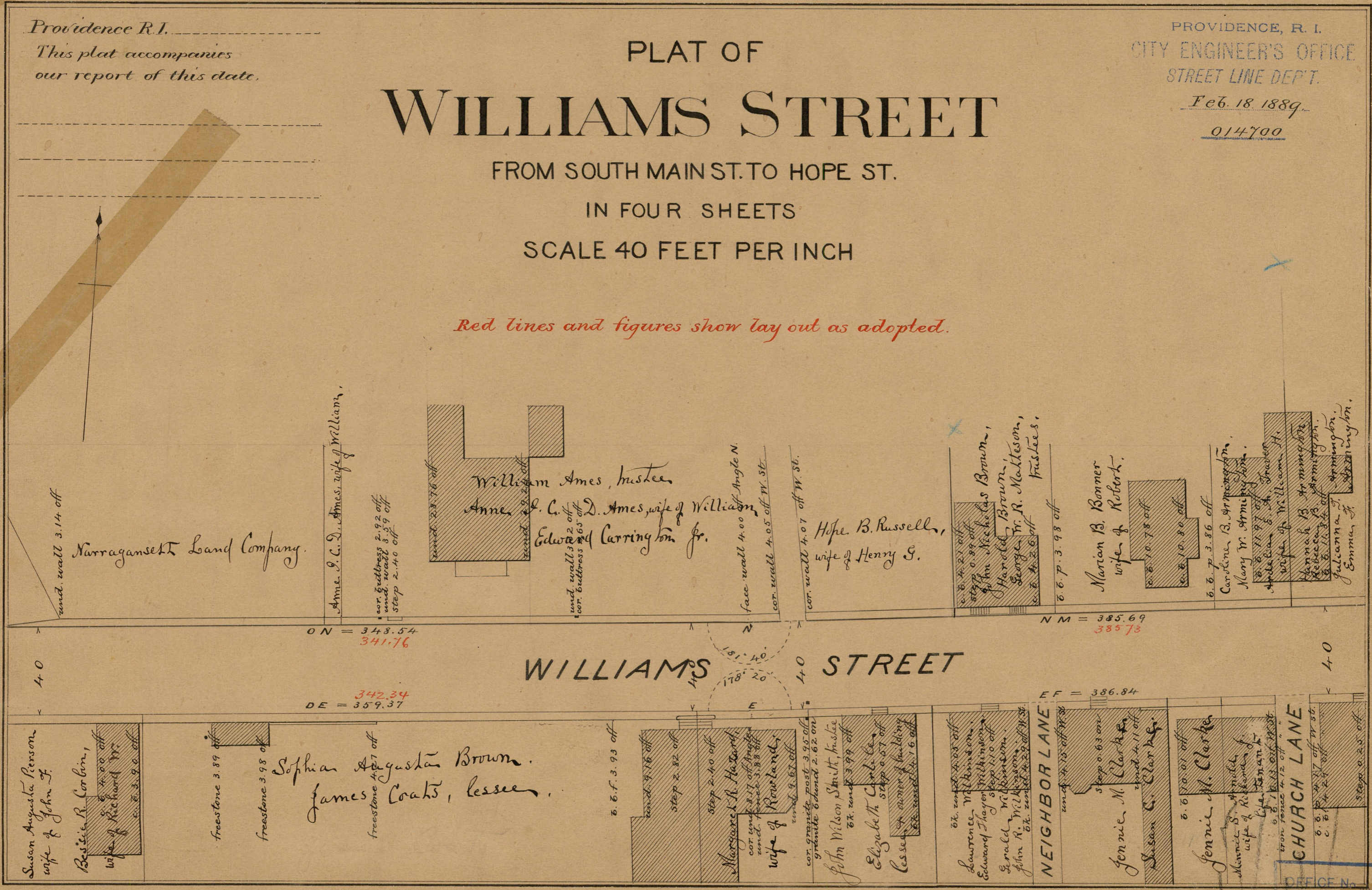

ON = 348.54
341.76
DE = 342.34
359.37

NM = 385.69
385.73

EF = 386.84

83
B-64

OFFICE No. 9947
DRAWER 83
SHEET B-64